

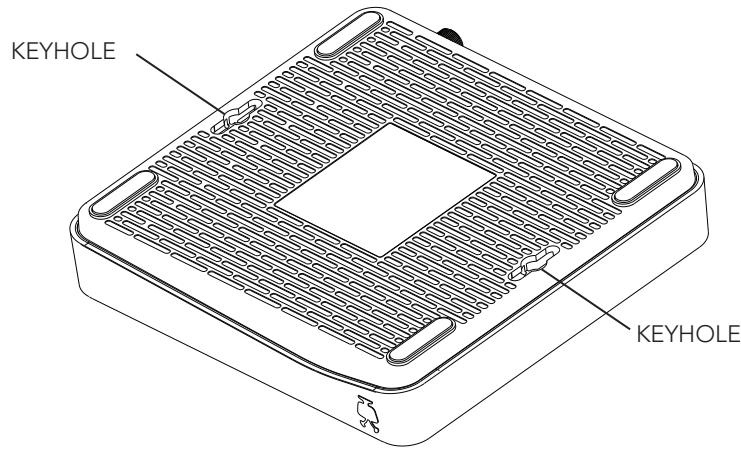

TiVo Mini VOX - Wall mounting instructions

The TiVo Mini VOX is designed to allow for mounting the unit on vertical surfaces such as a wall or on the inside of a cabinet. Vertical mounting is accomplished using the two keyhole slots on the bottom side of the product.



Keyhole locations

Step 1 - Get the correct mounting hardware. For mounting, #6 size screws are recommended. The image to the right shows the maximum dimensions for the mounting screw. Make sure to use the correct type of screws (and anchors) for the type of surface/wall the unit to which you are mounting unit. For example drywall anchors should be used when attaching to drywall.

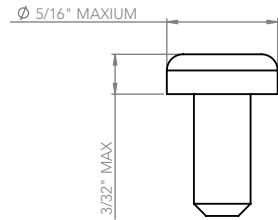

Maximum screw head dimension

Step 2 - Mark the screw location on the wall. Screws should be horizontally level and 4.92 inches apart. When printed to scale this guide can be used to accurately position the screws the correct distance apart. If using this document as a template, confirm the dimension below is correct by measuring.

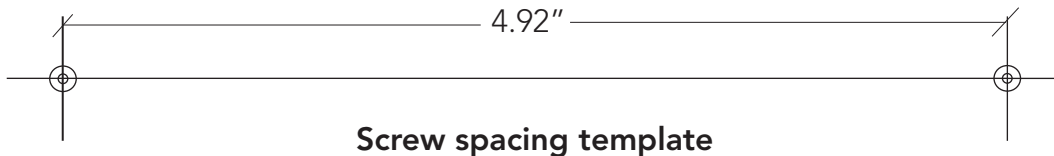

Step 3 - Attach screws to wall. If using an anchoring product, make sure to follow the manufacturers instructions. Leave the head of the screw protruding approximately 5/32 of an inch from the wall. Some adjustment might be needed to achieve the desired fit.

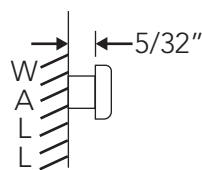

Screw clearance

Step 4 - Align keyhole slots with screws. Push the TiVo Mini VOX toward the wall until it touches, then gently slide the unit down until it stops.

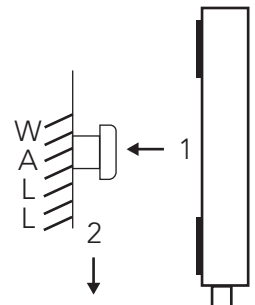

Final mounting